

INDEX	
SHEET NO.	SUBJECT
1	Index Sheet: Pavement Corrugations and Rumble Stripes
2	Pavement Corrugations for Centerline Rumble Stripes
3	Pavement Corrugations for Edgeline Rumble Stripes
4	Break in Rumble Stripe Corrugations near an Intersection, Drive, or Railroad
5	Pavement Corrugations for Shoulder Rumble Strips
6	Break in Rumble Strip Corrugations near an Intersection, Drive, or Railroad

GENERAL NOTE:

1. The corrugations shown herein depict sinusoidal corrugations. See Standard Drawing E 606-SHCG-01 thru E 606-SHCG-05 for conventional corrugations.

INDIANA DEPARTMENT OF TRANSPORTATION
INDEX SHEET: PAVEMENT CORRUGATIONS AND RUMBLE STRIPES

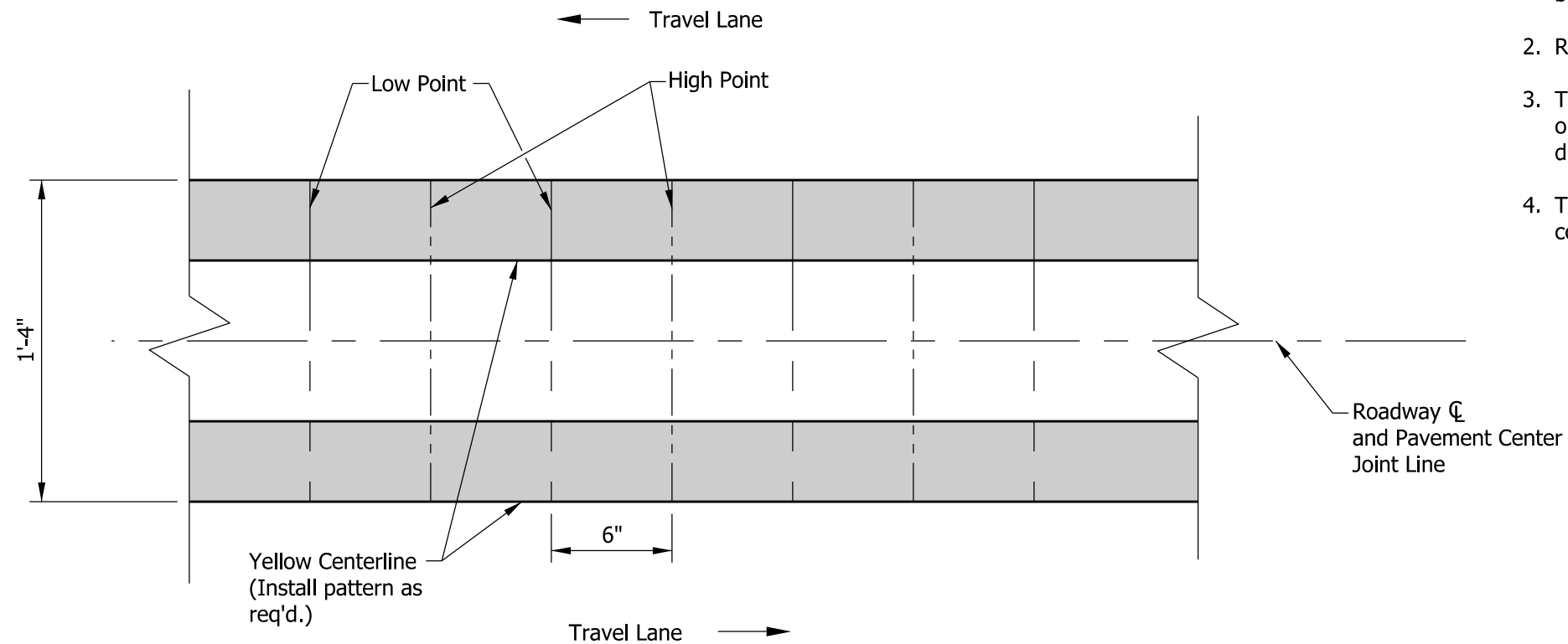

PLAN

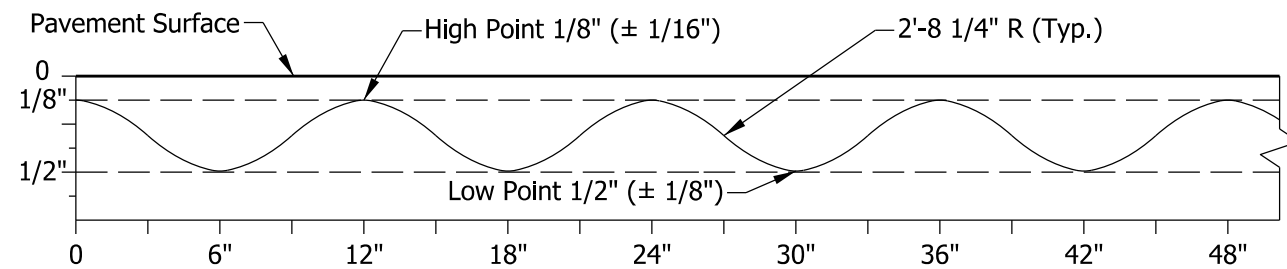

PROFILE

NOTES:

1. See Sheet 4 for break in rumble stripe near an intersection, drive, bridge, or railroad crossing.
2. Rumble stripe shall be centered about the roadway centerline.
3. The liquid asphalt sealant width shall be a minimum of 24 in. centered on the pavement center joint line, and shall be extended, where directed, to provide coverage beyond the edge of the corrugation.
4. The corrugations shall be no closer than 6 in. to a casting or a concrete pavement transverse joint.

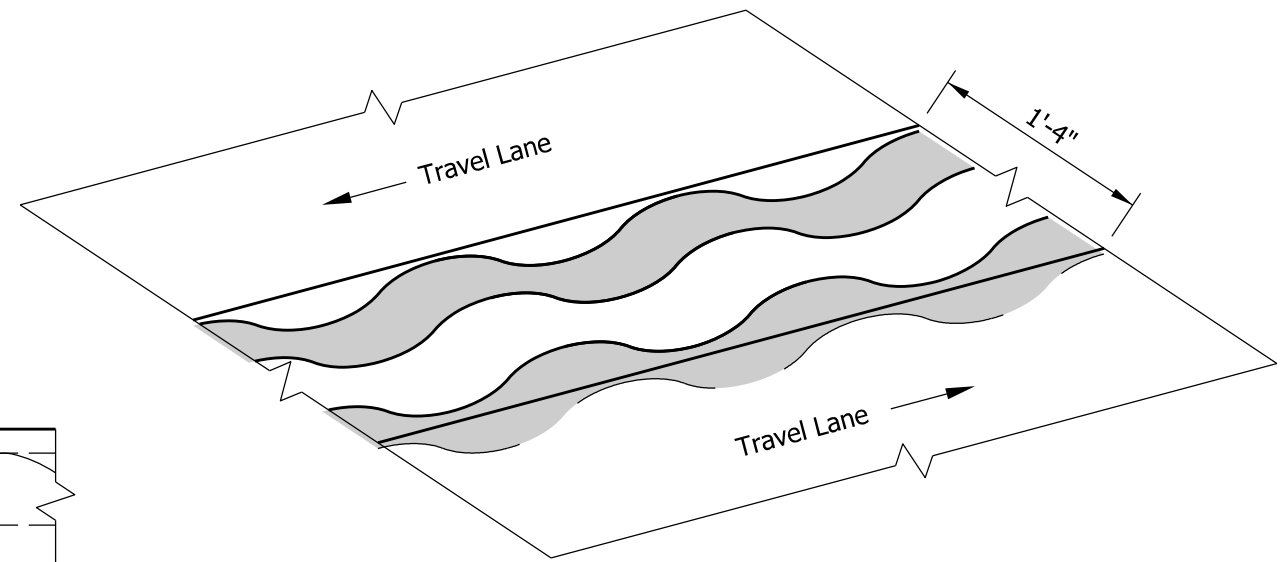

ISOMETRIC VIEW

INDIANA DEPARTMENT OF TRANSPORTATION

PAVEMENT CORRUGATIONS FOR
CENTERLINE RUMBLE STRIPES

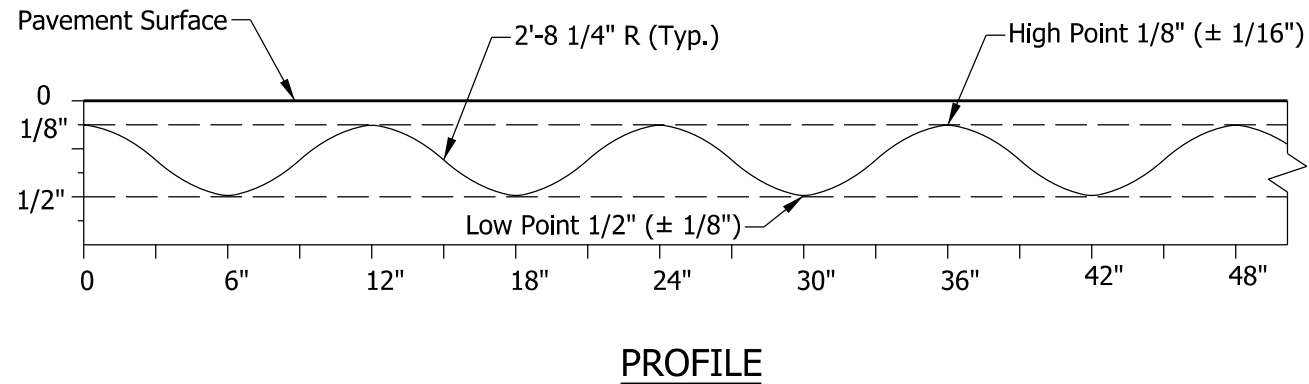
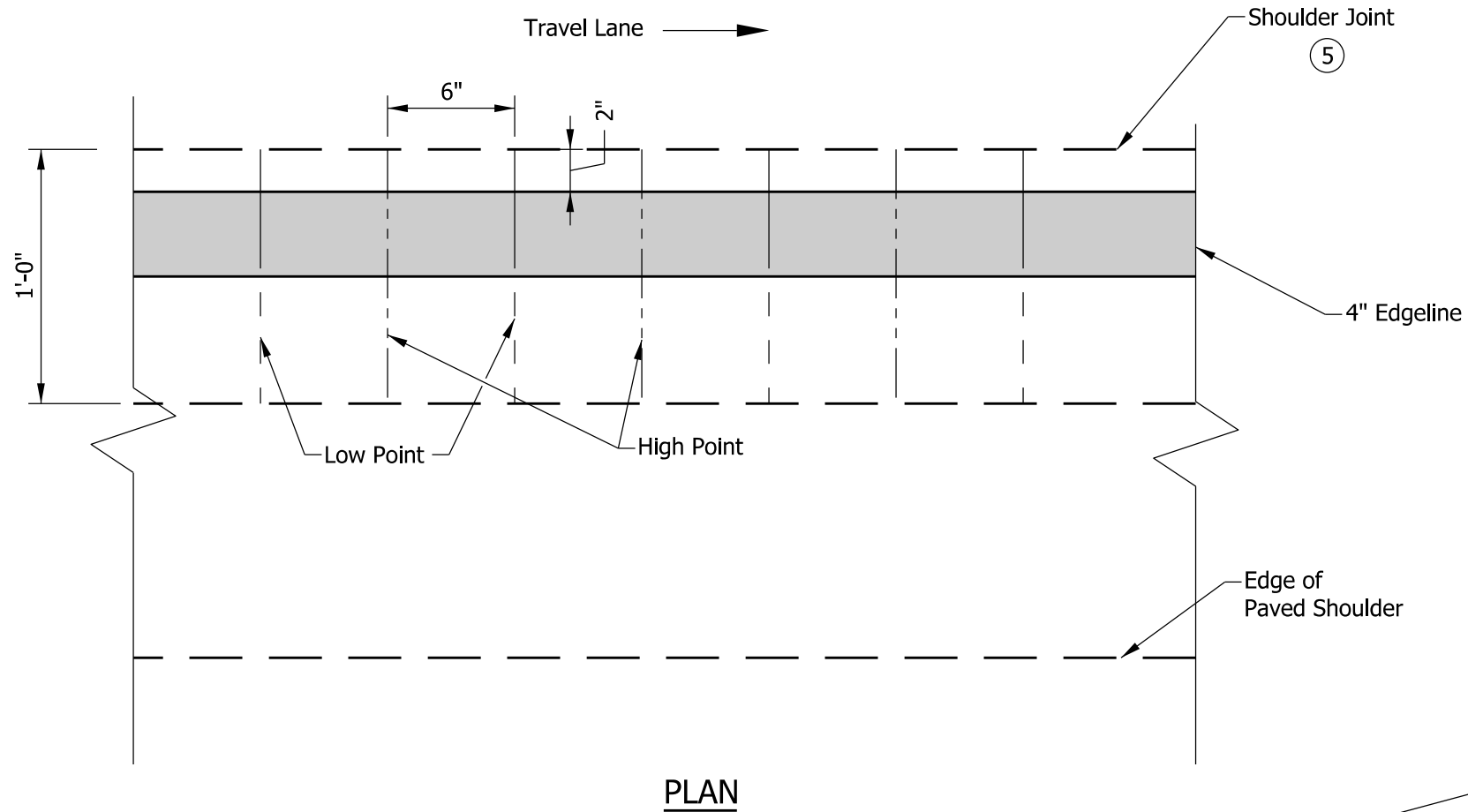

NOTES:

1. See Sheet 4 for break in longitudinal rumble stripe near an intersection, drive, bridge, or railroad crossing.
2. Where the paved shoulder width is at least 2 ft, a 12-ft longitudinal gap in the corrugations shall be provided every 60 ft to accommodate bicycles.
3. The liquid asphalt sealant width shall be a minimum of 24 in. centered on the shoulder joint line.
4. The corrugations shall be no closer than 6 in. to a casting or a concrete pavement transverse joint.
- ⑤ New edge of travel lane if shoulder joint is not apparent.

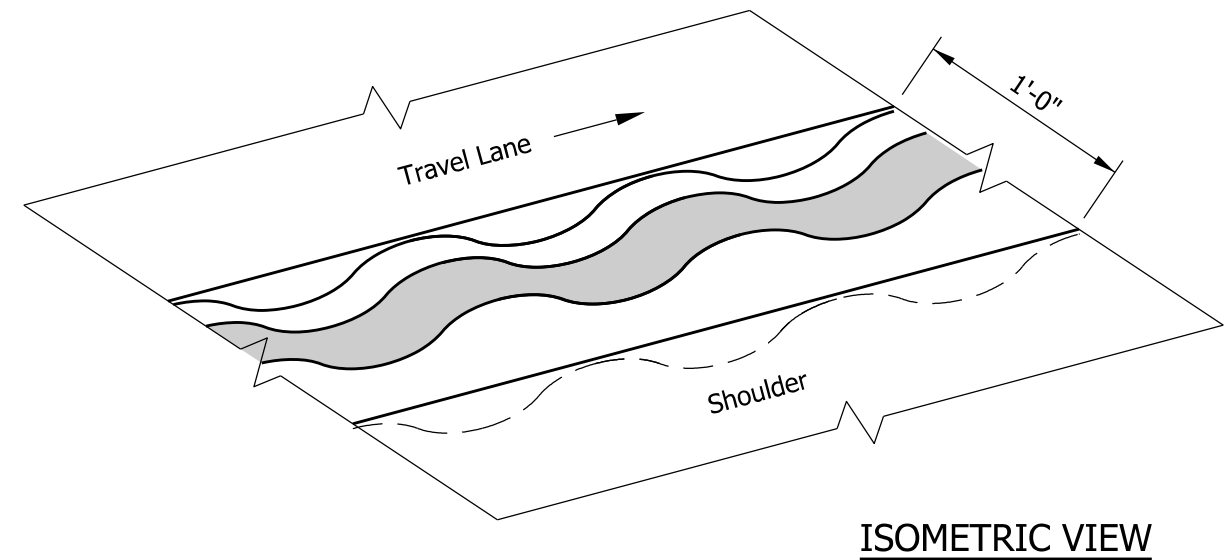

INDIANA DEPARTMENT OF TRANSPORTATION

PAVEMENT CORRUGATIONS FOR
EDGE LINE RUMBLE STRIPES

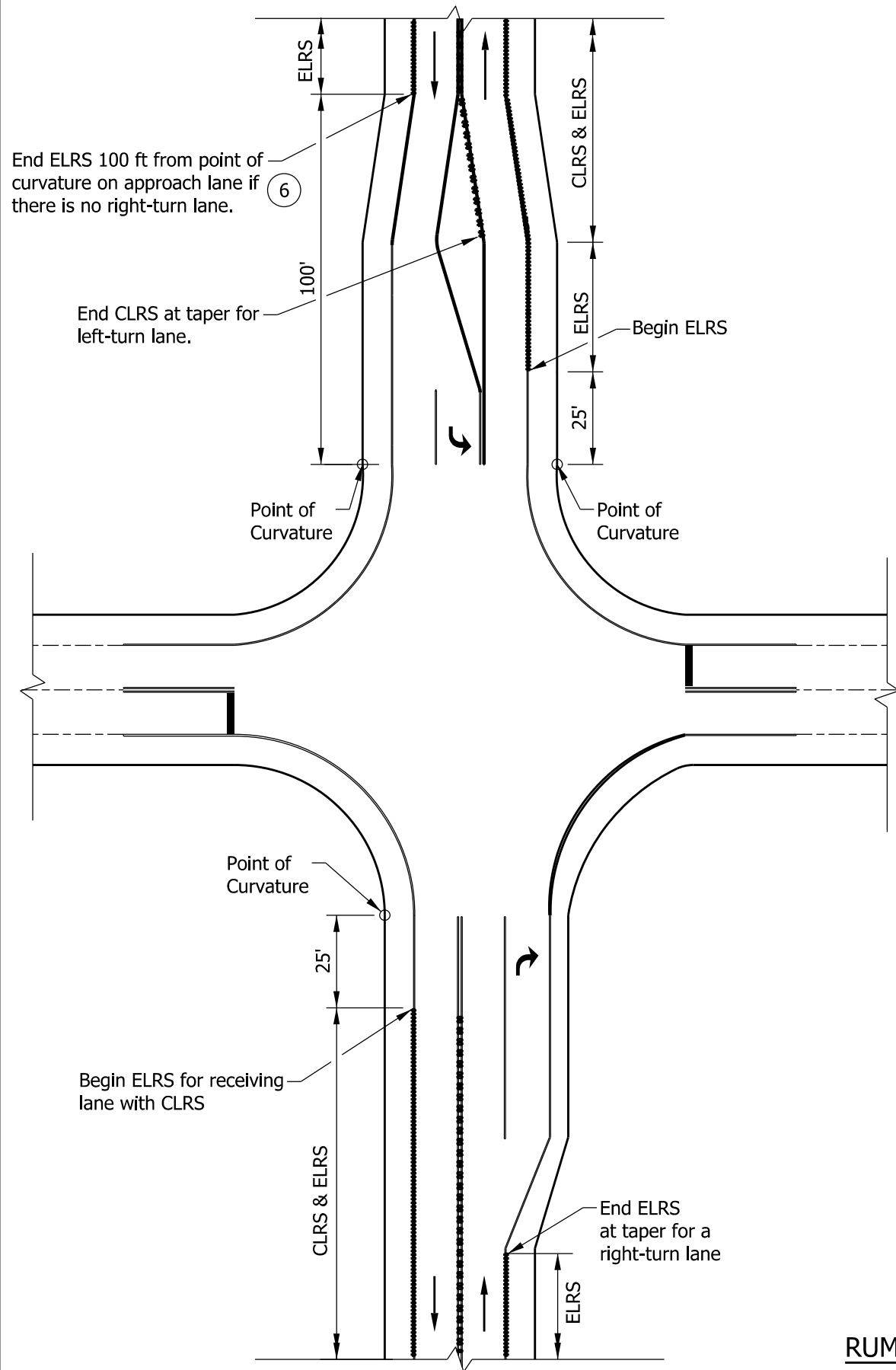

RUMBLE STRIPE BREAK NEAR AN INTERSECTION

KEY:

CLRS = Centerline Longitudinal Rumble Stripe
ELRS = Edgeline Longitudinal Rumble Stripe

NOTES:

1. See Sheet 2 for centerline corrugation pattern details and Sheet 3 for edgeline corrugation pattern details.
- ② Rumble stripe shall begin or end at the stop bar location.
- ③ Rumble stripe shall be continued through driveway access points for minor driveways.
- ④ Gap is 15 ft for a railroad crossing without gates or signals and 25 ft for railroad crossing with gates or signals.
5. For a bridge deck, end corrugations a maximum of 5 ft and a minimum of 6 in. before an approach slab and begin corrugations a minimum of 6 in. and a maximum of 5 ft after the approach slab on the other side of the bridge deck
- ⑥ End ELRS 400 ft from point of curvature on approach lane if there is no right-turn lane and the paved shoulder width is 8 ft or greater.

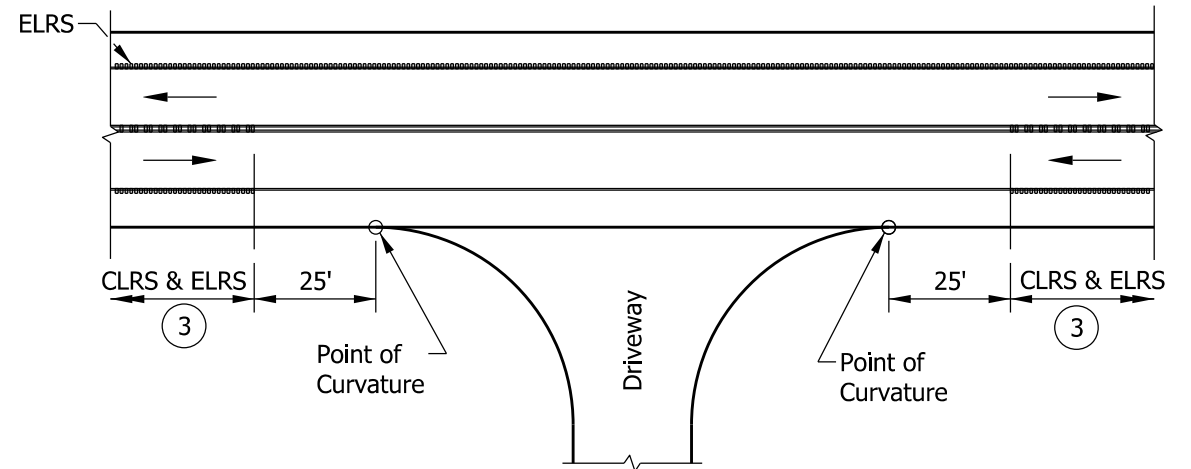

RUMBLE STRIPE BREAK NEAR A MAJOR COMMERCIAL OR INDUSTRIAL DRIVEWAY

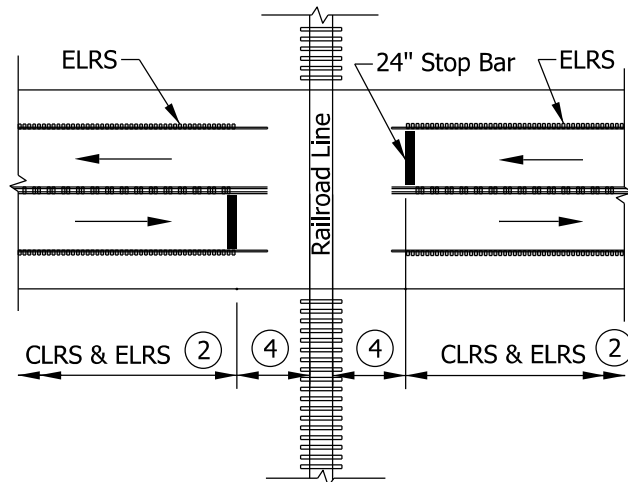

RUMBLE STRIPE BREAK NEAR A RAILROAD CROSSING

INDIANA DEPARTMENT OF TRANSPORTATION

**BREAK IN RUMBLE STRIPE
CORRUGATIONS NEAR AN
INTERSECTION, DRIVE, OR RAILROAD**

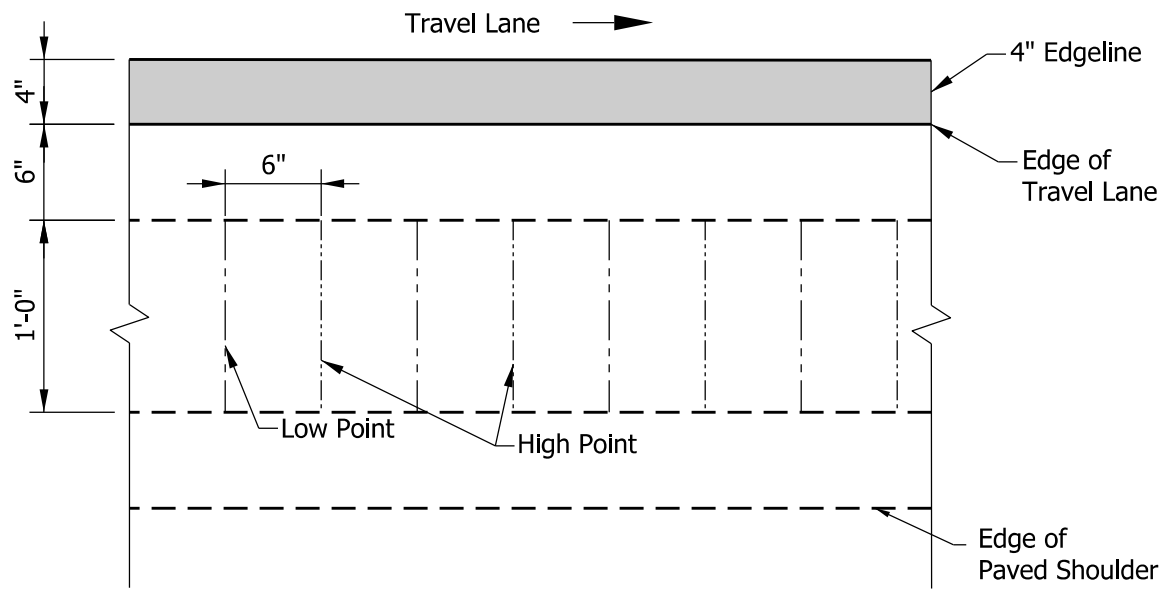

PLAN VIEW - WITH NO SHOULDER JOINT

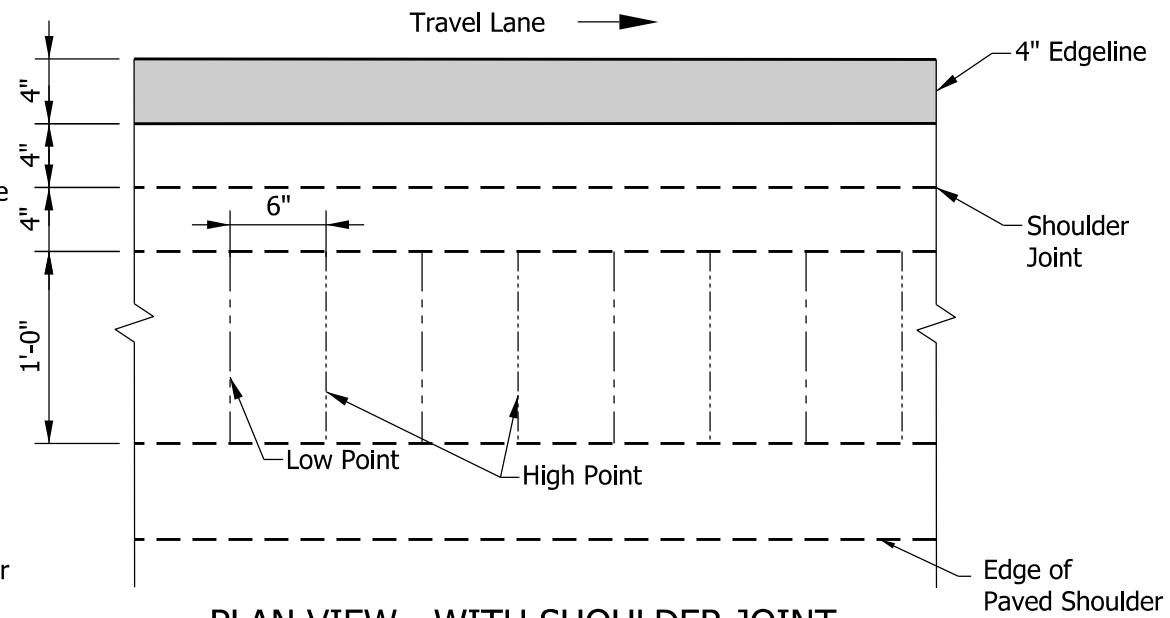

PLAN VIEW - WITH SHOULDER JOINT

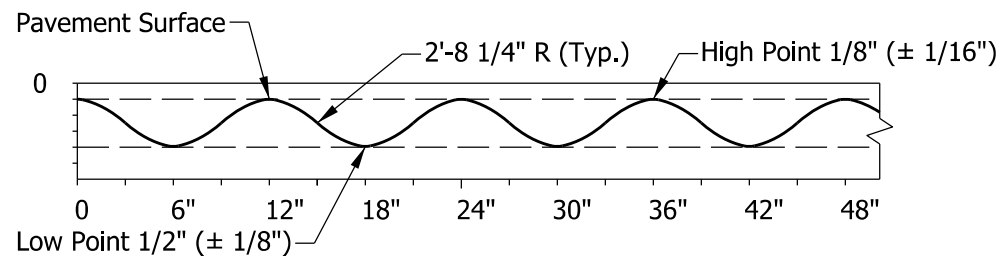

PROFILE

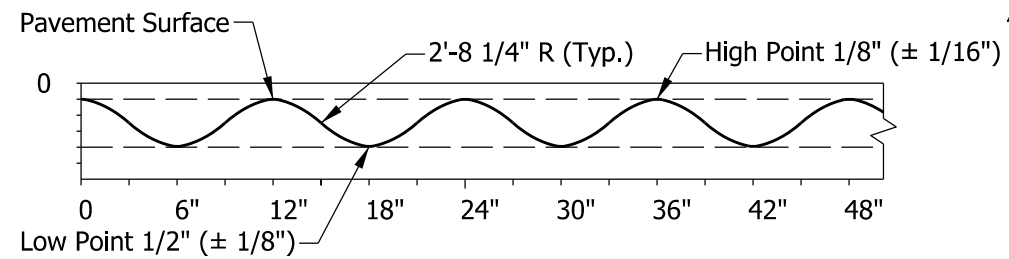

PROFILE

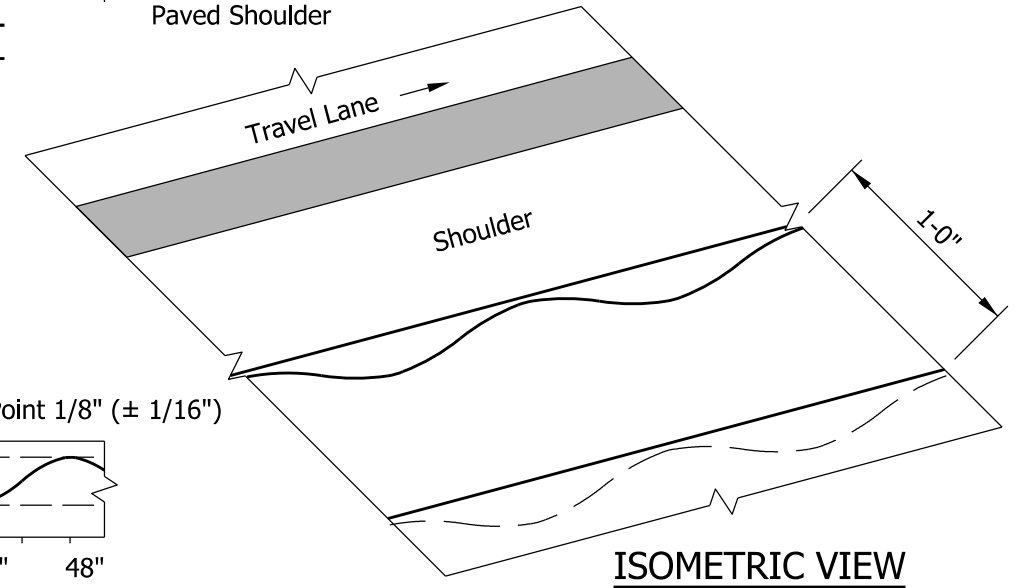

ISOMETRIC VIEW

NOTES:

1. See Sheet 6 for rumble strip placement near an intersection, drive, bridge, or railroad.
2. Where the paved shoulder width is at least 3 ft, a 12 ft longitudinal gap in the corrugations shall be provided every 60 ft to accommodate bicycles.
3. The liquid asphalt sealant width shall be a minimum of 24 in. centered on the shoulder joint line.
4. The corrugations shall be no closer than 6 in. to a casting.

INDIANA DEPARTMENT OF TRANSPORTATION

PAVEMENT CORRUGATIONS FOR
SHOULDER RUMBLE STRIPS
(Undivided Highway)

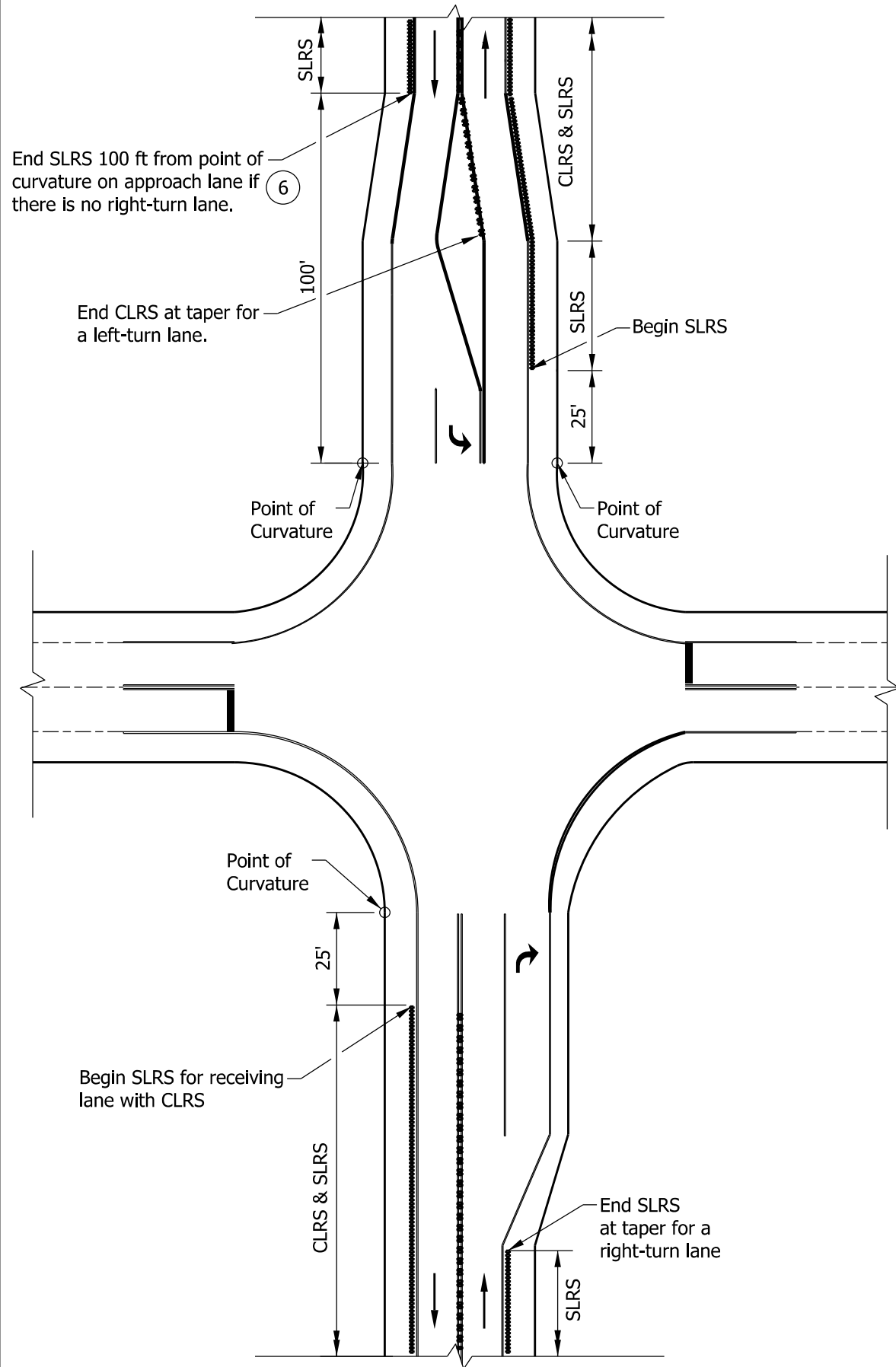

RUMBLE STRIP NEAR AN INTERSECTION

KEY:

CLRS = Centerline Longitudinal Rumble Stripe
SLRS = Shoulder Longitudinal Rumble Strip

NOTES:

1. See Sheet 2 for centerline corrugation details and Sheet 5 for shoulder corrugation details.
- ② Rumble strip shall begin or end at the stop bar location.
- ③ Rumble strip shall be continued through driveway access points for minor driveways.
- ④ Gap is 15 ft for a railroad crossing without gates or signals and 25 ft for railroad crossing with gates or signals.
5. For a bridge deck, end corrugations a maximum of 5 ft and a minimum of 6 in. before an approach slab and begin corrugations a minimum of 6 in. and a maximum of 5 ft after the approach slab on the other side of the bridge deck.
- ⑥ End SLRS 400 ft from point of curvature on approach lane if there is no right-turn lane and the paved shoulder width is 8 ft or greater.

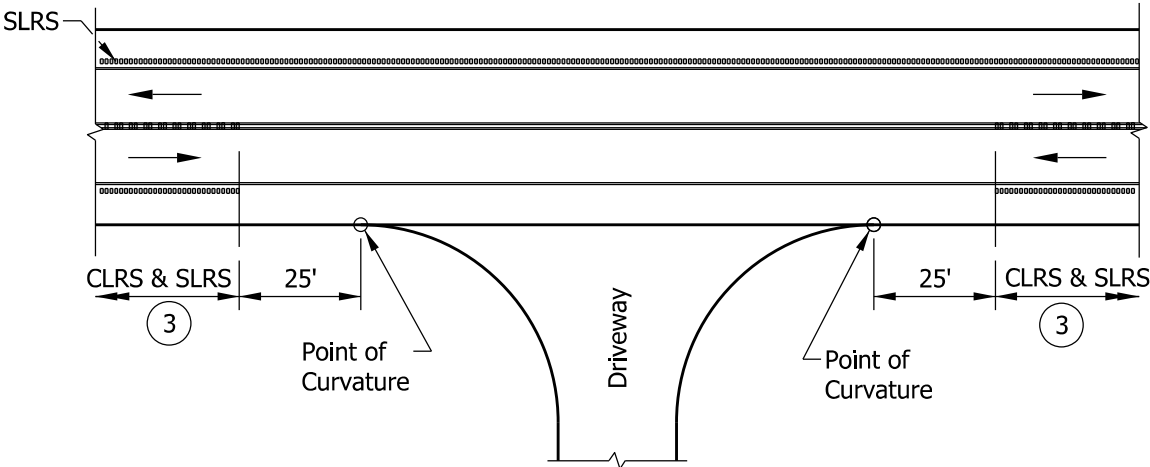

RUMBLE STRIP NEAR A MAJOR COMMERCIAL OR INDUSTRIAL DRIVEWAY

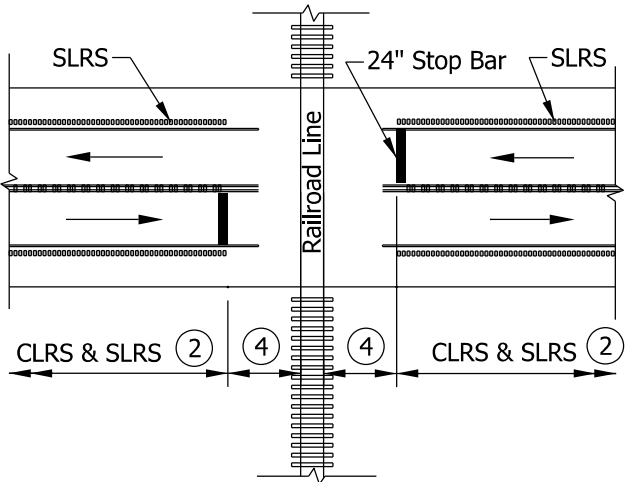

RUMBLE STRIP NEAR A RAILROAD CROSSING

INDIANA DEPARTMENT OF TRANSPORTATION

BREAK IN RUMBLE STRIP
CORRUGATIONS NEAR AN
INTERSECTION, DRIVE, OR RAILROAD